

RN Axles

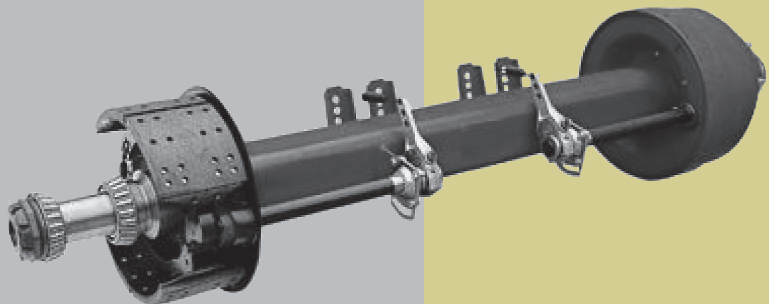

- 3-piece beam design with hardened bearing journals. Reduces the possibility of premature wear and tear on the spindle.
- Tubular construction ensures a smooth transition of strength between diameters. Reduces stress concentration, which in turn results in greater fatigue resistance.
- Each axle is completely welded with spindles, brake spiders, camshaft brackets and air chamber brackets.
- Axle beam and spindles are made of high grade steel.
- Choice of inboard and outboard drum configurations.
- Fully enclosed camshafts.
- Quick Release Brake Shoes.
- Quality tapered bearings.
- Asbestos free brake linings.
- Parts interchangeable with major brands.



The Perfect Balance

Quality, Reliability, Price and Excellent Services.

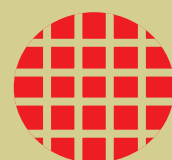

Rednet

ROBUST DESIGN & COST EFFECTIVE SOLUTION FOR THE INDUSTRY.....

Technical Specifications

	RNA12SISO1	RNBM13SISO1
Axle Capacity	12,000kg	13,000kg
Track Length	1850mm	1830mm
Beam Size	150 x 150mm	150 x 150mm
Beam Thickness	14mm	14mm
Spindle Nut Thread	2.5"	2 5/8"
Spindle Bearings	65/90 (TM)	66.67/90 (TN)
No. x Size of Wheel Studs x PCD	10 x M22 x 335	10 x M22 x 335
Wheel Fixing	ISO	ISO
Brake Drums	Inboard Design	Outboard Design
Brake Size	420 x 180mm	420 x 180mm

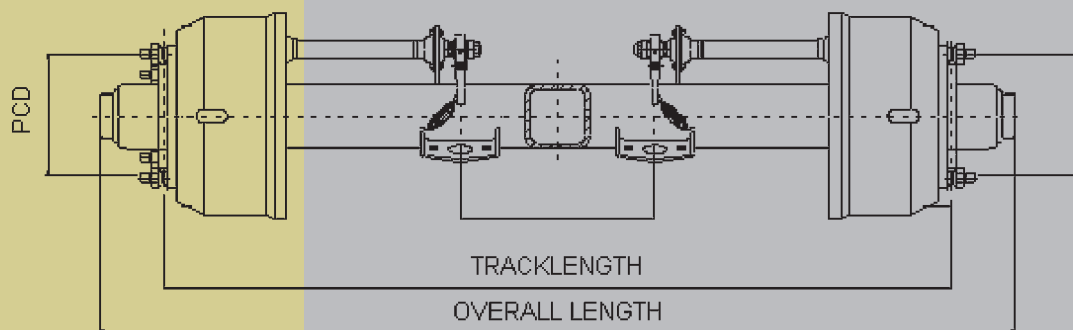

STANDARD SUPPLY:

- Complete with manual slack adjusters
- Limited warranty period

OPTIONAL:

- Auto slack adjuster
- ABS ready kit

Rednet Pte. Ltd.

6 Pioneer Sector 1, Singapore 628418
 Tel: 65-68978525 Fax: 65-68978231
 Email: sales@rednet.com.sg
 www.rednet.com.sg



Rednet